

# 240 PLOW PINS

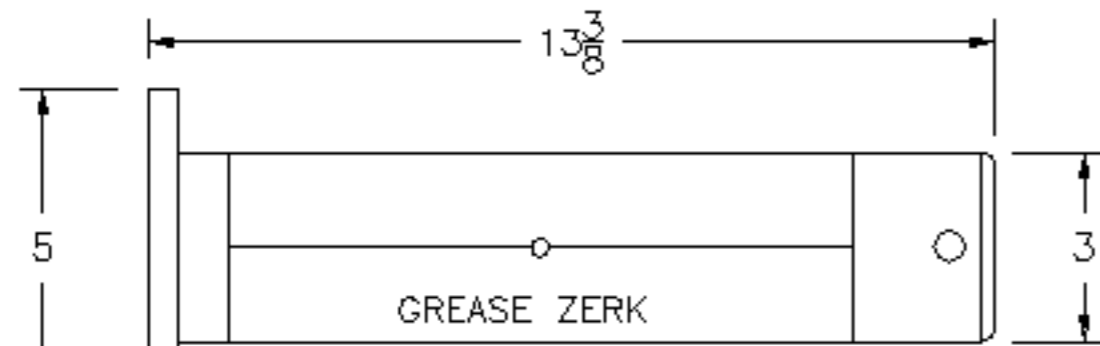

(2) LIFT CYLINDER HSG. TO LOWER PLOW ARM  
PART #4752-0026

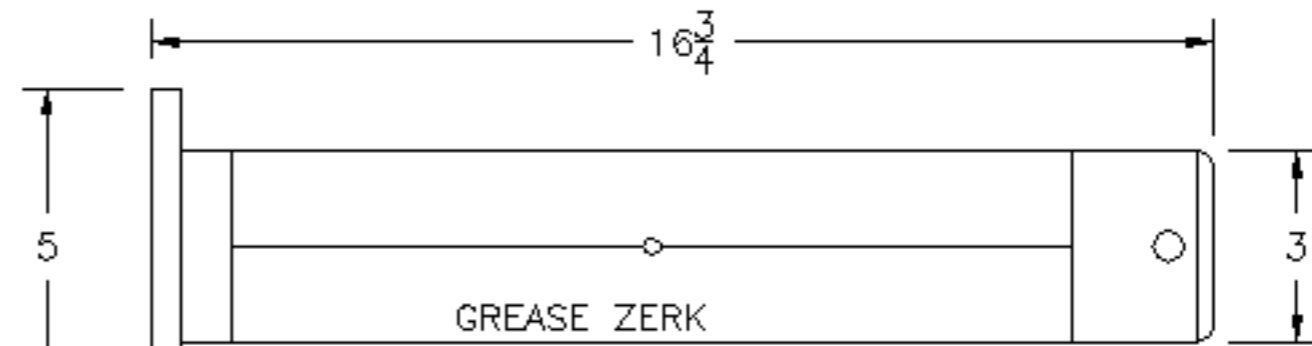

(2) REAR SWIVEL HEAD TO UPPER PLOW ARM  
(2) REAR SWIVEL HEAD TO LOWER PLOW ARM  
PART #4752-0027

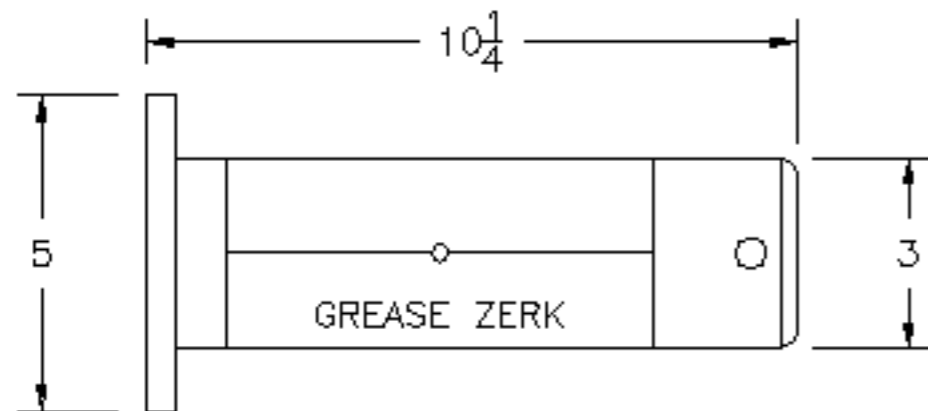

(2) LIFT CYLINDER HSG TO BACKPLATE PIVOT  
(2) REAR SWIVEL HEAD TO SHAKER BOX PIVOT  
PART #4752-0032

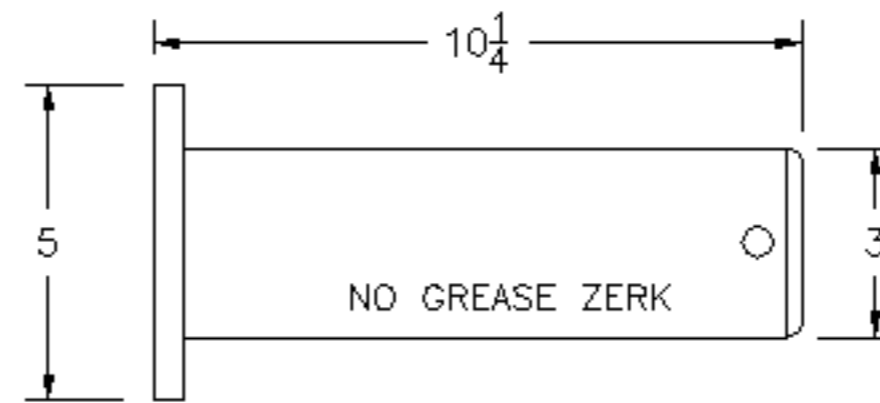

(2) STEERING CYLINDER T-END  
(2) SWING CYLINDER T-END  
PART #4752-0030

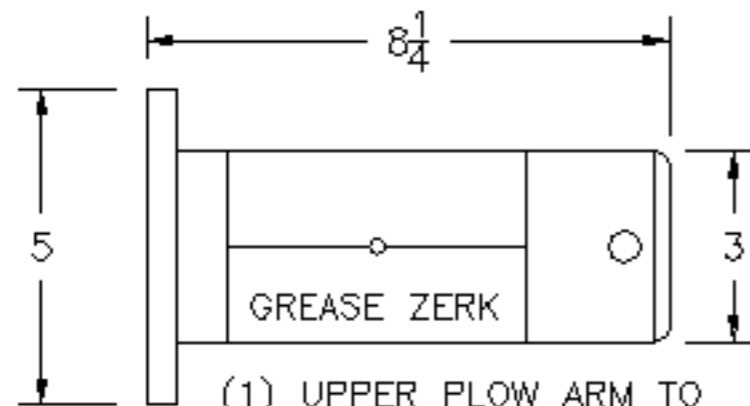

(1) UPPER PLOW ARM TO LIFT CYLINDER HSG.  
PART #4752-0029

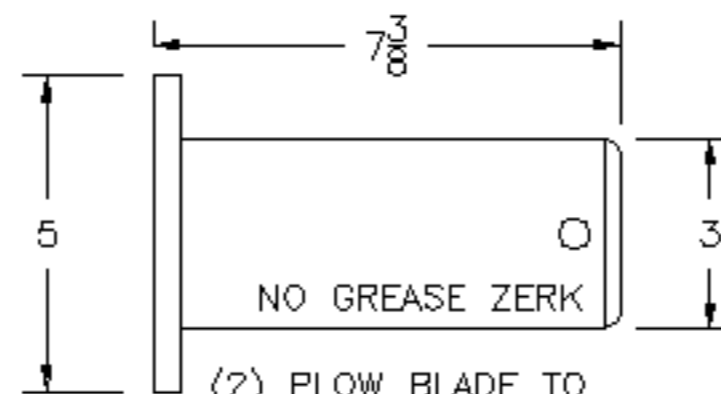

(2) PLOW BLADE TO SHAKER BOX BLADE MOUNT  
PART #4752-0028

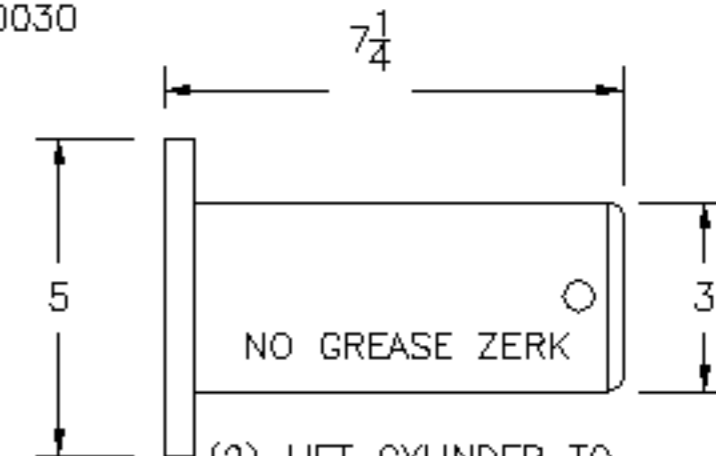

(2) LIFT CYLINDER TO LOWER PLOW ARM  
PART #4752-0031

NOTE: 4752-0028 AND 4752-0031 HAVE BEEN COMBINED USING AN OFF-CENTER BOLT HOLE COLLAR. 4752-0030 MAY SHOW THE GREASE GROOVES IN THE PIN BUT WITHOUT THE ZERK FITTING.

**DELTA**  DELTA EQUIPMENT, LLC  
3000 SIDNEY LANIER DRIVE (912) 264-1553  
BRUNSWICK, GA 31525 FAX (912) 264-1503